

SPECIFICATIONS



SDP10K5S

SOUND-PROOF TYPE

DIESEL GENERATOR SET

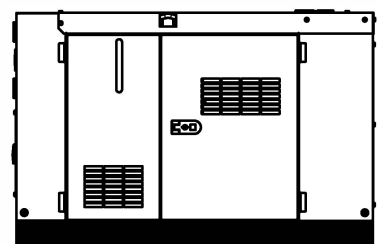

DP series
SDP10K5S
50 Hz @ 1500rpm, 1-phase/2-wiring

1 Standards & Conditions

Design Standards

The designs and the productions are in conformity with:

- ISO8528
- GB/T2820
- YD/502-2007
- JB/T20136-2006

Environmental Operating Conditions

- Installation place: Outdoors or indoors (well ventilated).
- Ambient temperature: -25°C to 45°C. The coolant heater is needed when the temperature is below 5°C
- Humidity: Less than 80%.
- Altitude: Below one thousand (1000) meters above sea Level.

Factory Inspection

- Inspection items.
- Protection devices working test.
- Starting ability in normal temperature.
- 50% rated power load moment capability.
- Voltage deviation and speed variation: 0%, 25%, 50%, 75%, 100%, 110% Load.

Painting Process

- Painting process specifications and colors are based on the manufacturer's standard.
- The customer could also choose the color which the manufacturer offers.

2 General Features

- Kubota engine D1105-BG
- Microprocessor control module PLC-920
- NADER main circuit breaker: 50A
- Rotate speed governor: Mechanical governor
- Excitation system: Self excited, SHUNT
- A.V.R model: DSR
- Power Factor: 1.0

- Key switch
- Emergency stop switch
- ATS(automatic transfer switch)receptacle
- Remote run connector
- 1x12V/60AH sealed for life maintenance free battery
- Lockable battery isolator switch
- Powder coated canopy
- 45°C radiator
- Steel base frame
- Vibration isolators between the engine/alternator and base frame
- Dry type air filter
- fuel tank for 11 hours running
- Operation Manual / Specifications

3 Equipment Specification

General technical data

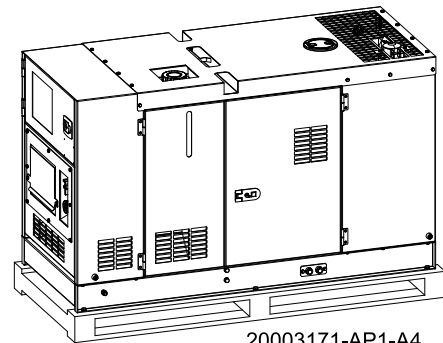

| | |
|----------------------------------|--------------------|
| Model..... | SDP10K5S |
| Tank capacity..... | 33L |
| Dry weigh..... | 551kg |
| Sound pressure level @ 7m | N/A |
| Sound power acc. 2000/14/EC..... | N/A |
| Dimensions L×W×H..... | 1400 x 700 x 900mm |
| Standby Power | 8.8kW |
| Prime Power | 8kW |
| Voltage/Ampere | 220V/43A |

| Genset Fuel Consumption | | | | | |
|-------------------------|-----|-----|-----|------|------|
| Frequency/Load | 25% | 50% | 75% | 100% | 110% |
| 50Hz (L/h) | N/A | 1.6 | 2.2 | 2.9 | 3.5 |

Diesel engine

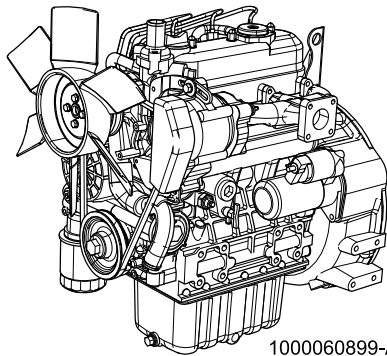

1000060899-AP1-A5

| | |
|---------------------------------|--------------------------|
| Engine Manufacturer/Brand..... | KUBOTA |
| Engine Model..... | D1105-BG |
| Dimensions L×W×H..... | 549.3×398.0×604.7mm |
| Dry Weigh (approx.) | 93kg |
| Number of Cylinders..... | 3 |
| Bore..... | 78mm |
| Stroke | 78.4mm |
| Displacement..... | 1.123L |
| Compression Ratio | 22 |
| Type of injection..... | N/A |
| Intake System..... | Natural aspirated |
| Intake Resistance | 1.96kPa |
| Cooling System | Water cooled |
| Fan | Pusher |
| Battery Voltage | 12V |
| Type of Fuel..... | No.2-D(ASTMD975) |
| Type of Oil | Better than API CD class |
| Oil Capacity | 5.1L |
| Type of Coolant | Glycol mixture |
| Coolant Capacity | 6.4L |
| Back Pressure | ≤7.07kPa |
| Standby Power | 9.5kW |
| Prime Power..... | 8.4kW |
| Fuel Consumption(100%load)..... | 220g/kW.h |

Alternator

1000221765-AP1-B2

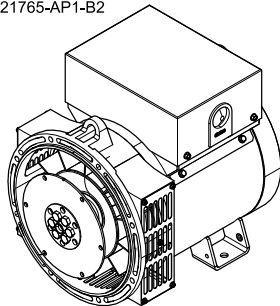

PLC-920 Control System

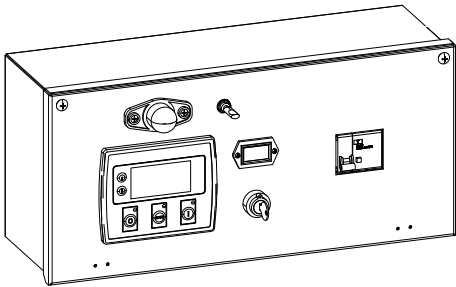

1000340679-AP1-A1

PLC-920 is an advanced control module based on microprocessor designed to control the engine via push buttons on the front panel. The module is used to start and stop the engine and indicate fault conditions, automatically shutting down the engine and giving a true first up fault condition of an engine failure.

Standard Control Function

- Manual Engine Control Module
- Low Oil Pressure
- High Engine Temperature
- Auxiliary Shutdown
- Overspeed Protection
- Protection hold-off timer
- Charge Failure warning

4 Overall Dimensions

20003171-DR1-A4

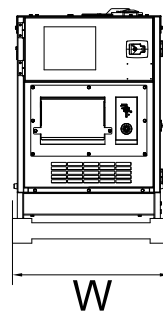
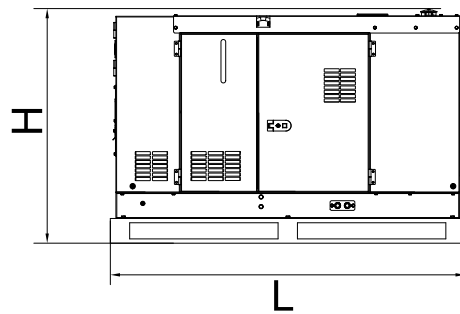
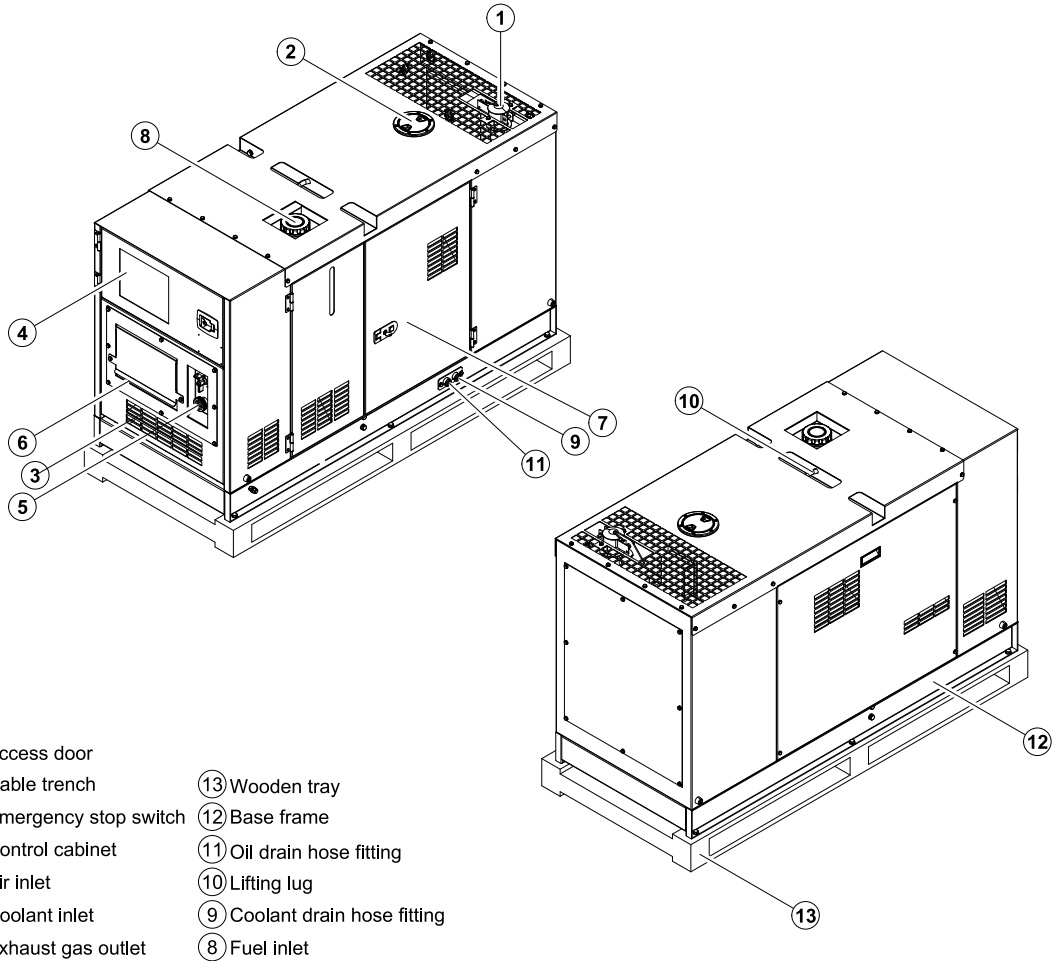

5 Control System

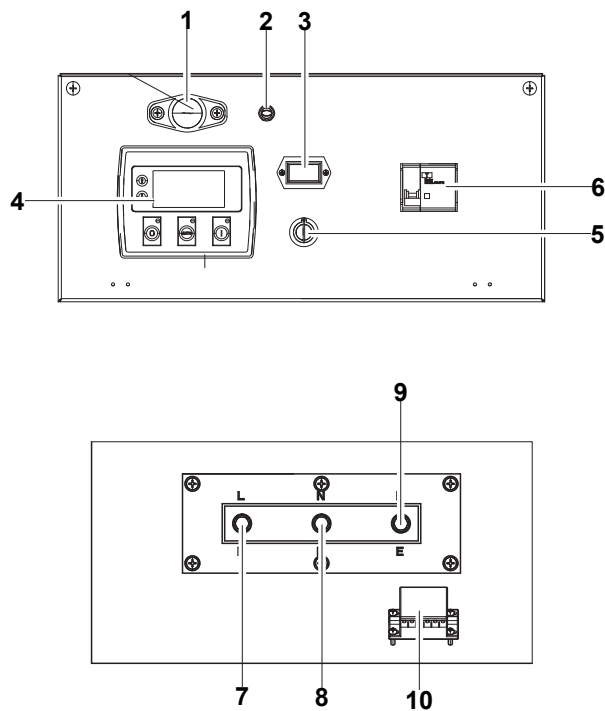

| Ref. | Description |
|------|-----------------------------|
| 1 | Control cabinet lamp |
| 2 | Control cabinet lamp switch |
| 3 | Time counter |
| 4 | Control module |
| 5 | Key switch |
| 6 | Main circuit breaker |
| 7 | Live wire terminal |
| 8 | Neutral wire terminal |
| 9 | Ground wire terminal |
| 10 | Remote control/Mains input |

Control & field wiring cabinet

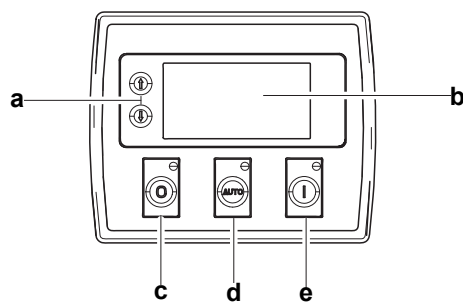

Control module

| Ref. | Description |
|------|---|
| a | Navigation button«» Accept (Configuration mode only) |
| b | Main status display |
| c | Stop/reset button«» Next page (Configuration mode only) |
| d | Auto start button«» Decrease value/next item (Configuration mode only) |
| e | Start button«» Increase value/next item (Configuration mode only) |

6 Optional Accessories

1. ATS Cabinet

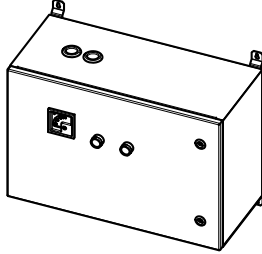

- Adopt advanced ATS with high quality
- High reliability, high stability, ease of operation

2. Automatic Oil Drain Pump

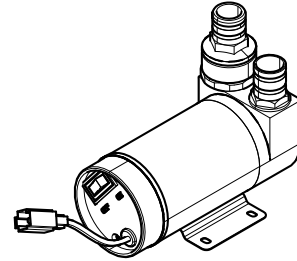

- Drain the oil from engine automatically
- Easy to operate with inching switch

20004002-OA1

3. Battery Charger

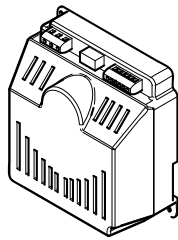

- Switch power supply structure, wide input alternating voltage range, small size, light weight, high efficiency rate
- Short-circuit protection

4. Double Layer Air Filter

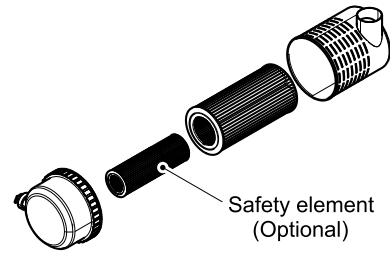

- Air filter with safety element
- High filtration precision and filtering ability

5. Spark Arrestor

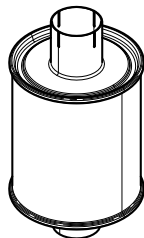

- Any explosive exhaust particles can be captured in dangerous environment.

6. Water Jacket Preheat Unit

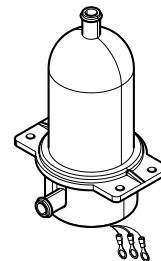

- Water jacket preheat unit should be used to start the engine quickly if the temperature is lower than 5°C
- The preheat unit is equipped with a thermostat

| |
|---------------|
| 20003171-A4-E |
| 09.2017 |